

**COPYRIGHT RESERVED:**  
 The Contractor shall verify and be responsible for all dimensions. DO NOT scale the drawing - any errors or omissions shall be reported to Seven Architecture without delay. The Copyrights to all designs and drawings are the property of Seven Architecture. Reproduction or use for any purpose other than that authorised by Seven Architecture is forbidden.

- GENERAL NOTES:**
1. For the purposes of construction the drawing must not be scaled and only written or calculated dimensions
  2. Any queries or doubts, drawing error or divergences should be referred to the originator.
  3. All dimensions to be checked on site.
  4. All architectural drawings are to be read in conjunction with the relevant architectural specifications and technical reference sheets (T-Sheets).
  5. All the details and setting-out drawings to be read in conjunction with the relevant consultants and subcontractor drawings.

REV	DESCRIPTION	DATE	DRAWN	CHECK
P01	Planning submission	13/12/2022	RD	SP

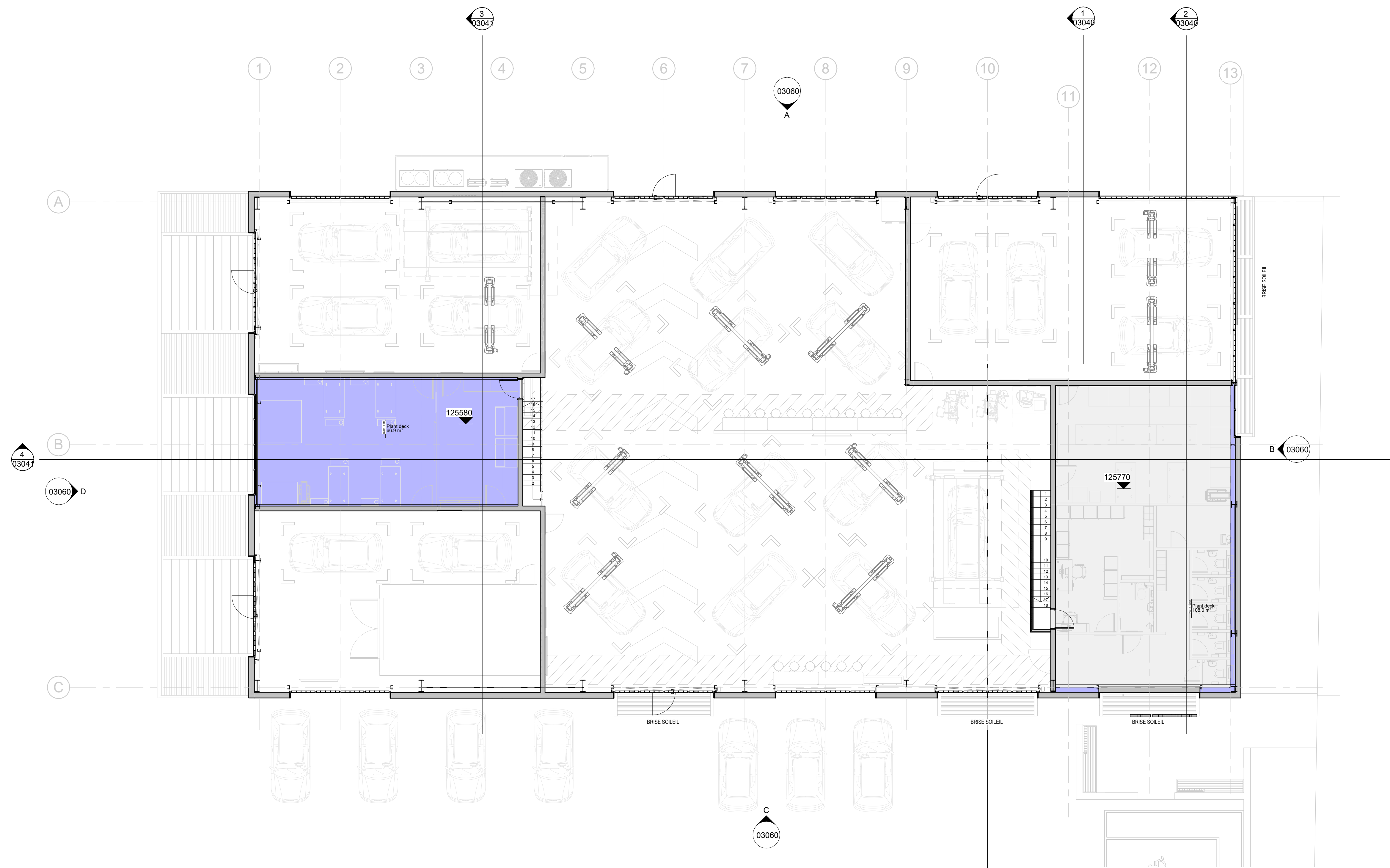

**DRAWING SCALE:**  
 1:100 @ A1

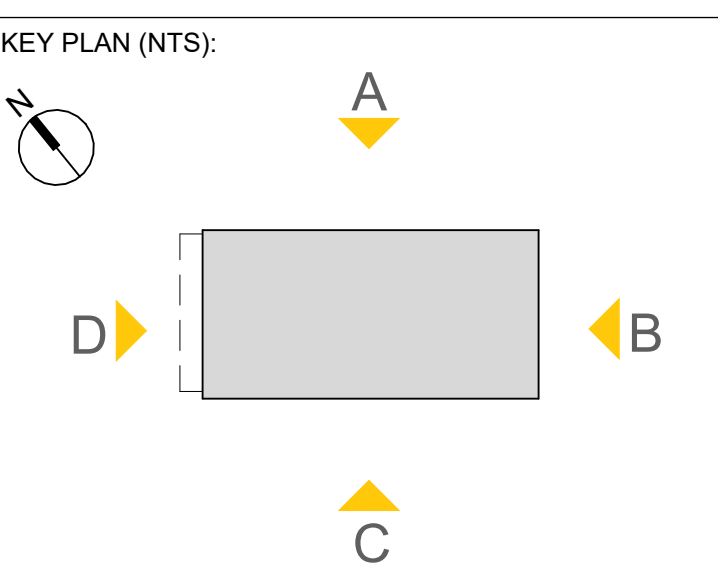

**CLIENT:**  
**Tameside College**

<b>PROJECT TITLE:</b> Tameside FECTF	<b>PROJECT NO.:</b> 20710
---	------------------------------

**DRAWING TITLE:**  
 MV - Level 01 - Proposed Mezzanine Floor Plan

**DRAWING NO.:**

PROJECT	ORIGIN	ZONE	LEVEL	TYPE	ROLE	NO.#	REVISION
TAM	SEV	Z3	01	DR	A	02021	P01

**SUITABILITY DESCRIPTION:** (S5) Suitable for Approval

**REVISION DESCRIPTION:** PLANNING

**seven.**  
 SEVENARCHITECTURE.CO.UK

Studios at:

Unit 1.3 Wauk Mill 51 Bengal St MANCHESTER M4 6LN t: 0161 236 5655	Clarendon House Victoria Avenue HARROGATE HG1 1JQ t: 01423 709 807	Y Neuadd Lwyd Dolwyddelan CONWY LL25 1GJ t: 07772819425	24 Greville Street Clerkenwell LONDON EC1N 8BS t: 0203 036 0691
--	--	---	---